

It is convenient to set the timer for the time when you go to bed ,when you get home ,when you get up , ect.

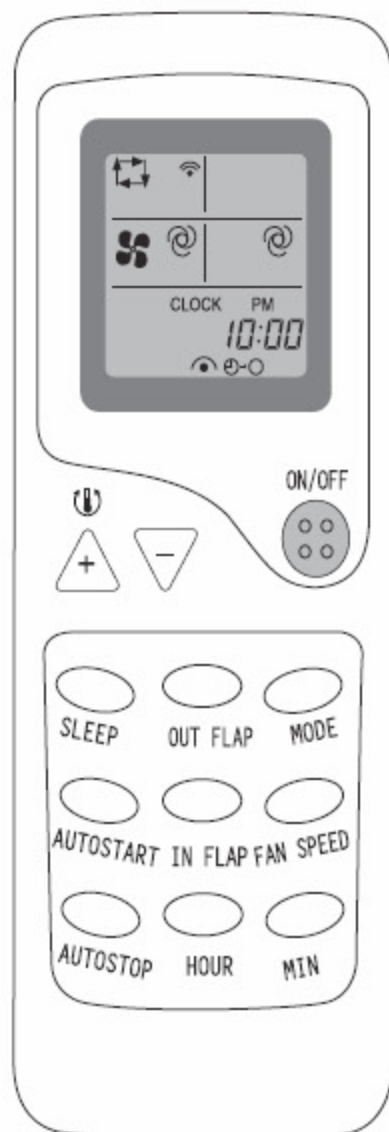

### How to set the ON timer

- 1 Press the AUTO START button to set the on timer mode when the AC is in the standby mode.**  
Each time the button is pressed, the ON timer mode alternates between ON and OFF.
  - 2 Set the time of the timer using the HOUR and MIN buttons.**  
Each time the HOUR button is pressed , the Set time is counted up by 1 hour; each time the "MIN" button is pressed, the set time is counted by 10 minutes.
- **To release the ON timer:**  
Press the AUTO START button to release the timer.

### HOW to set the OFF timer

- 1 Press the AUTO STOP button to set the OFF timer mode during operation.**  
Each time the button is pressed, the OFF timer mode alternates between ON and OFF.
  - 2 set the time of the timer using the HOUR and MIN buttons.**  
Each time the HOUR button is pressed , the Set time is counted up by 1 hour; each time the "MIN" button is pressed, the set time is counted by 10 minutes.
- **TO release the OFF timer:**  
Press the AUTO STOP button to release the timer.

#### Programming timer operation

The ON timer and OFF timer can be used in combination .The time of the set time which is reached first will operate first (↔ mark indicates the order of timer operations.)

- If the current time has not been set ,the timer operation cannot be done.

## 【Features of Heating Operations】

### Basic principles and performances

- The machines absorb heat from the outdoor air and transfer it indoors so as to heat the room air. The heating capabilities through this principle of heat pump go up/down with the increase/decrease of the temperatures of the outdoor air.
- It only needs a fairly short time for such hot air circulation system to raise the room temperature.
- When the outdoor air temperature is very low, the system can be used together with other heating devices. But good ventilation should be maintained to ensure safety and prevent accidents.

### Defrosting

When the outdoor air temperature is very low and humidity is very high, frosting will occur to the heat exchanger of the outdoor unit, which has negative impacts upon the efficiency of the heating performance. In such case, the automatic defrosting function will come into play. The heating operation will be stopped for 5-10 minutes to do the defrosting.

- During the defrosting, the outdoor unit might generate some steam. It is caused by fast defrosting, which is not a performance failure.
- Upon the completion of the defrosting process, the heating operation is resumed.